

TURNKEY® Grizzly pins Installation and Removal

Assembly instructions



Equipment : The use of the TK D 3-9 tool is recommended for TURNKEY® Grizzly teeth assembly/disassembly. Always work safely and wear your safety equipment (hard hat, steel-toed shoes, gloves, safety glasses). Keep bystanders away.



Cleaning : Tilt the bucket 30° upwards. Before inserting Turnkey sleeve in its housing, we recommend to clean the adapter sleeve housing as well as the adapter nose to make sure the sleeve will be correctly positioned into the sleeve housing.

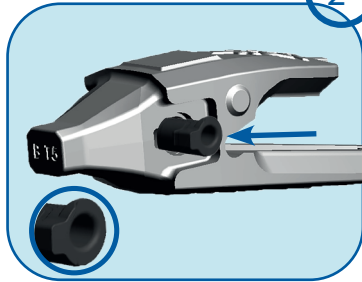

Sleeve insertion : Manually insert the sleeve. You will notice on the sleeve & the adapters some notches to make sure to respect the sleeve insertion direction. The use of spray or silicone grease is recommended for better installation.

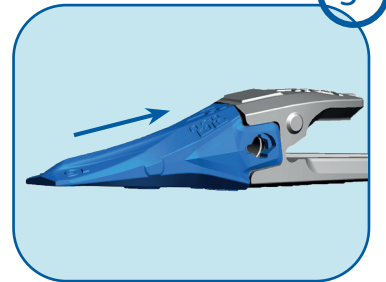

Tooth assembly : Install the TURNKEY® Grizzly tooth on the adapter.

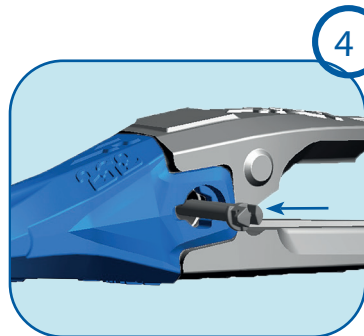

Pin insertion : Once the teeth is correctly installed on the adapter, insert the pin into the key hole while respecting the insertion direction (pin head left), then push it to the end. The pin as well as the sleeve have mechanical codings to avoid any incorrect insertion.



Pin insertion (2) : Before pin clamping, the pin should be in "head left" position.

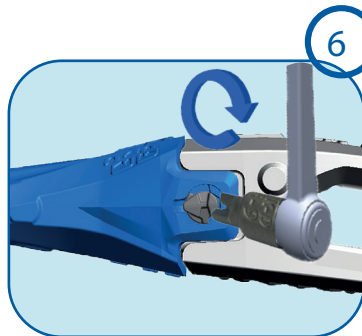

Pin clamping : Once inserted, take the TK D 3-9 clamping sleeve (installed on a square or ratchet wrench) and insert it into the key housing. Tighten and lock by turning 180° clockwise, while pushing in the pin.



Correct positioning : Pin is correctly installed when the pin will be locked as shown. Do not force beyond the mechanical stop, as this is impossible.



Correct locking : Once the pin has been correctly installed and locked, the pin should be in "head right" position.

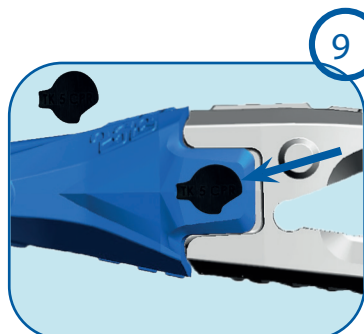

Protective caps installation : On right teeth sides, insert the protective caps to avoid fines to fill up the pin hole. These protective caps will allow you to decrease teeth replacement time.

TURNKEY® Grizzly pins Installation and Removal

Disassembly instructions



Equipment : The use of the TK D 3-9 tool is recommended for TURNKEY® Grizzly teeth assembly/disassembly. Always work safely and wear your safety equipment (hard hat, steel-toe shoes, gloves, safety glasses). Keep bystanders away.



Removing protective caps: Before disassembling the pin, remove the protective cap using a flathead screwdriver, and clean any material in the pin head, so that the removal tool's appendix can be properly inserted into the pin.

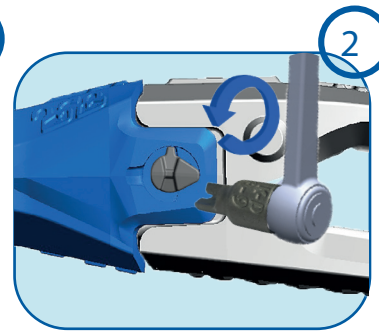

Unpinning: Once the TK D 3-9 clamping sleeve has been inserted into the pin head, unlock the pin by turning it counter-clockwise through 180°. Then lever out the pin with a screwdriver.



Correct unlocking (2): Once unlocking is complete, your pin should be in this position in this position: **Head Left**

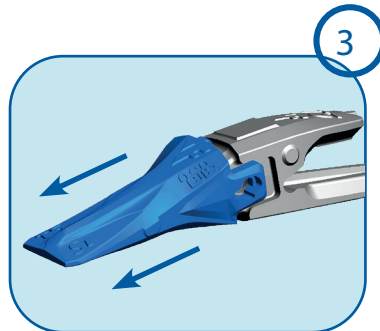

Teeth removal : Once the pin is removed, you can easily remove teeth

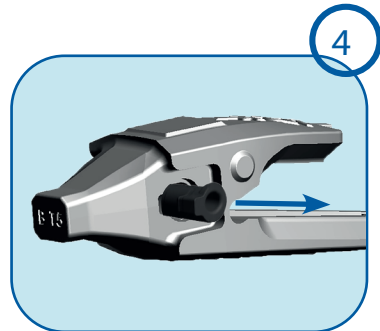

Sleeve removal : To eject the sleeve, take a screwdriver and extract it if it doesn't come out by hand.



Cleaning : Clean the adaptor, the sleeve hole and throw away the used locking device. When fitting a new tooth, use a new pin and a new sleeve.

