

# 125-0800 FEU

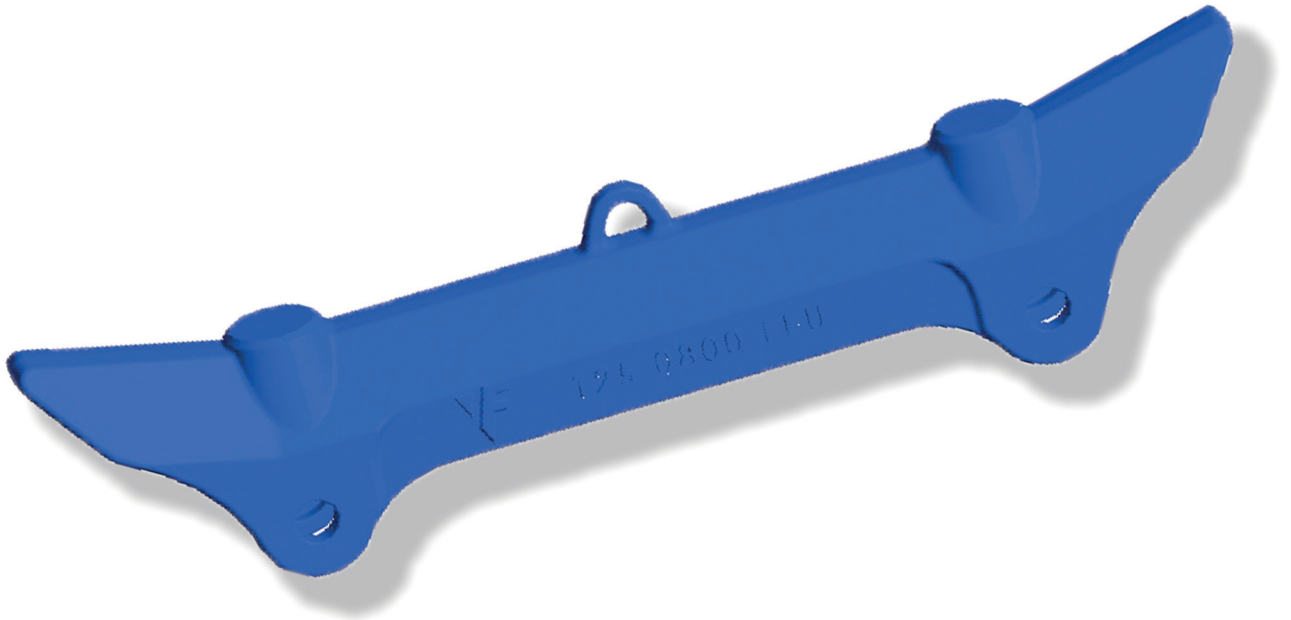

**Bouclier s'installant sur des flancs de 60mm/2.5in minimum**

**Shroud to fit 60mm/2.5in minimum on wing**

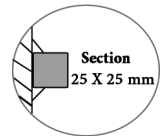

**RECOMMANDATION DE MONTAGE**

Afin d'assurer la stabilité du montage, il est recommandé de souder de chaque côté de la lame un profilé de section carrée et de longueur 466 mm 0 / -2 .

**INSTALLATION ADVISE**

To make sure the part will stay correctly fitted, we advise to weld a 466 mm length plate on both protection sides.

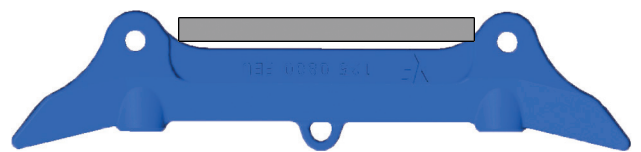

A

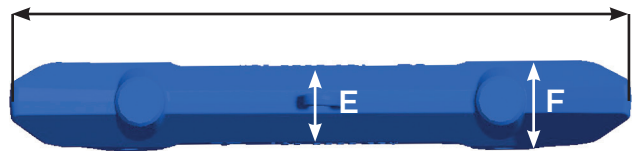
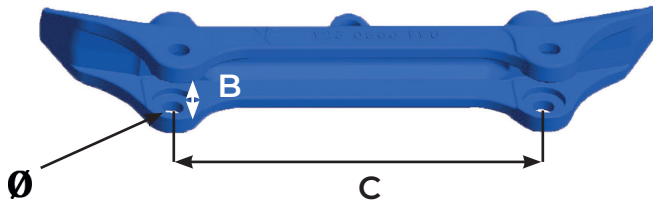

**Clavetage conseillé Ref: 125 0800 CL + 4T4707**  
**Advise Pin & Ring Ref:**

Référence Part number	Poids Weight Kg/Lbs	A mm/in	B mm/in	C mm/in	D mm/in	E mm/in	Ø mm/in	Epaisseur de Flanc / Wing Thickness (mm/in)
125-0800 FEU	60 132.28	985 38.78	72 2.83	600 23.62	135 5.31	122 4.8	35 1.38	65 2.56

